

# सुरक्षित निवेश योजना

(PDPMY) फेज-2



**REGISTRATION AMOUNT RS.31000**

## **DELHI MALL COMPLEX**

Project is under PPP model with DDA  
(Rera No.: DLRERA2018P0013)

महिलाओं व सीनियर सिटीजन के लिए 33% आरक्षित एवं 5% छूट

CONSTRUCTION LINKED PLAN

Floor	Area (Approximate)*	Total Basic Cost(TBC)	Registration Fees	10% Booking Amount (within 7 days)	10% of TBC within 45 Days/ ATS	30% of TBC within 90 Days	10% of TBC within 9/12/15 months from booking (As per Construction)	20% on Offer of Possession
Ground Floor	100 SQ. FT.	Rs. 1,04,44,900	₹31,000	Rs. 10,44,490	Rs. 10,44,490	Rs. 31,33,470	Rs. 10,44,490	Rs. 20,88,980
First Floor	40 SQ. FT.	Rs. 35,81,080		Rs. 3,58,108	Rs. 3,58,108	Rs. 10,74,324	Rs. 3,58,108	Rs. 7,16,216
Second Floor	50 SQ. FT.	Rs. 37,30,300		Rs. 3,73,030	Rs. 3,73,030	Rs. 11,19,090	Rs. 3,73,030	Rs. 7,46,060
Third Floor	50 SQ. FT.	Rs. 52,22,450		Rs. 5,22,245	Rs. 5,22,245	Rs. 15,66,735	Rs. 5,22,245	Rs. 10,44,490
FOOD COURT	150 SQ. FT.	Rs. 1,41,00,000		Rs. 14,10,000	Rs. 14,10,000	Rs. 42,30,000	Rs. 14,10,000	Rs. 28,20,000

DOWN PAYMENT PLAN

Floor	Area (Approximate)*	Total Basic Cost(TBC)	Registration Fees	10% Booking Amount (within 7 days)	20% of TBC within 45 days/ATS	50% of TBC within 90 days	20% On Offer of Possession
Ground Floor	100 SQ. FT.	Rs. 94,67,500	₹31,000	Rs. 9,46,750	Rs. 18,93,500	Rs. 47,33,750	Rs. 18,93,500
First Floor	40 SQ. FT.	Rs. 32,46,000		Rs. 3,24,600	Rs. 6,49,200	Rs. 16,23,000	Rs. 6,49,200
Second Floor	50 SQ. FT.	Rs. 33,81,250		Rs. 3,38,125	Rs. 6,76,250	Rs. 16,90,625	Rs. 6,76,250
Third Floor	50 SQ. FT.	Rs. 47,33,750		Rs. 4,73,375	Rs. 9,46,750	Rs. 23,66,875	Rs. 9,46,750
FOOD COURT	150 SQ. FT.	Rs. 1,27,81,000		Rs. 12,78,100	Rs. 25,56,200	Rs. 63,90,500	Rs. 25,56,200

\*Allocated area will be undivided share under any unit as per sanctioned building plans as declared under RERA and post lease will be converted into units under SM REIT.

\*GST & other charges as applicable

CONSTRUCTION  
IN FULL SWING



SCAN QR CODE  
TO WATCH  
CONSTRUCTION UPDATE

**GROUND FLOOR**



**FIRST FLOOR**

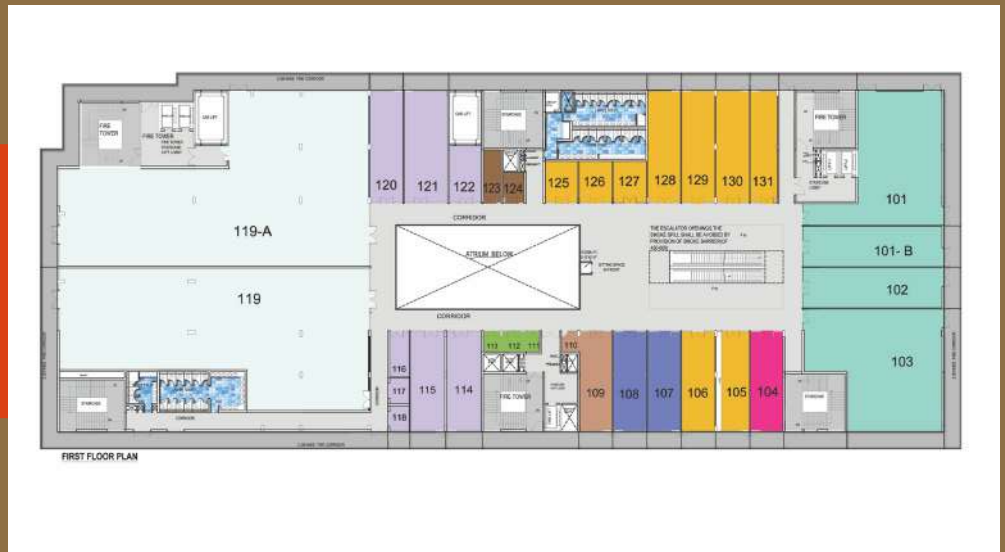

**SECOND FLOOR**

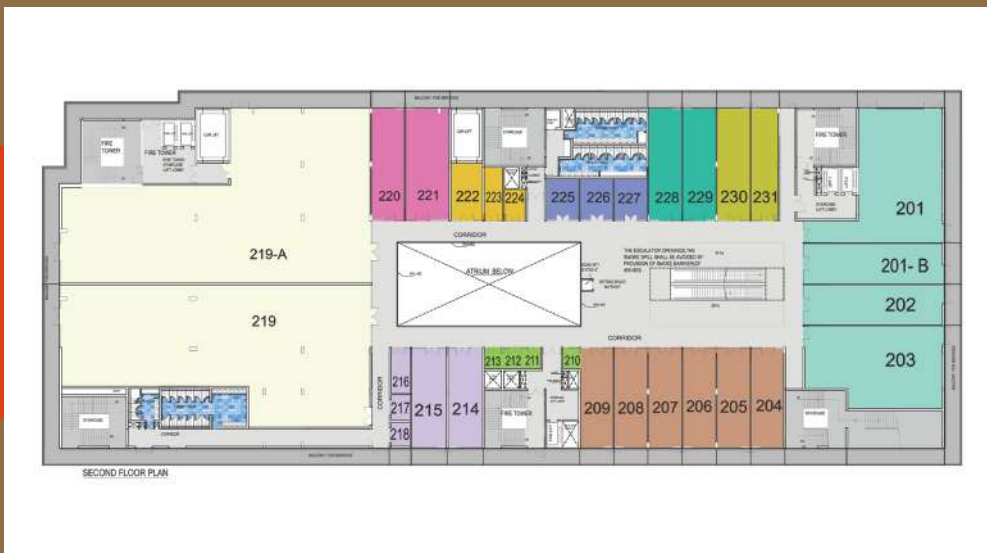



**THIRD FLOOR**



**AMENITIES**



**FOOD COURT**



**SHOWROOMS**



**MULTILEVEL CAR PARKING**



**RETAIL**



**CINEMA**



**APPLY ONLINE**

**LOCATION**

**FOR IMMEDIATE ONLINE REGISTRATION**



Ph, +91 76204-70000 | Web: [www.delhimallscomplex.com](http://www.delhimallscomplex.com)

Disclaimer: The Project is under PPP scheme with DDA and the same is registered with Real Estate Regulatory of NCT of Delhi vide registration no. DLRERA2018P0013 dated 26.06.2018, PR/RERA/2018/3886 Dated: 16/12/2022. Sanction building plan no. CA/BP/0062/19-20 (11 October 2019). Approvals can be checked at the Company's or RERA's website or at our office. The image shown here is pictorial conceptualization and actual may differ. The information and contents provided herein are subject to change within the provisions of Act and norms. This is neither an offer nor an investment advice nor an inducement or invitation for payment of any advance and/or deposit. It is just information about the project. The right of customers will be limited to undivided ownership rights in unit and pro rata common areas while lease rights will remain pre assigned. This project is charged to EARC (Edelweiss Assets Reconstruction Company Limited). Please carefully read and peruse all terms and conditions, specifications and payment plans in the Application Form as well as locations, sanctions, permissions, Delhi RERA registration conditions, intimations, applications and clearances before tendering your booking. It is further abundantly clarified that by participating, you consent to the inclusion of your A-grade Future Revenue Generating property in the SM RET scheme. You'll receive units in proportion to your property allotment and income distributions per SEBI (REIT) Regulations as may be amended from time to time and subject to applicable approvals. 1 Hectare = 2.471 Acres = 4840 Square Yards or 4046.856 Square Meters; 1 Square Yard = 0.8361 Square Meter; 1 Square Meter = 10.764 Square Feet. <http://dda.org.in/rera/>